

District Council Report

December 2021

Planning Committee met on 1st December, with two applications in Burwell on the agenda. A solar farm off Ness Road was granted approval, I raised concerns over the cumulative impact of these developments around Burwell. An application for an extension on Isaacson Road was refused by a majority vote. Committee also approved: the creation of a new recreation ground in Haddenham; a replacement dwelling in Littleport; construction of a 2-storey extension in Soham and the installation of numerous illuminated information signs around Ely.

I also attended a meeting a meeting of the Cambridgeshire and Peterborough Combined Authority Audit & Governance Committee which received and approved the annual accounts and annual governance statement for 2020/2021. Committee also considered the corporate risk register and agreed to join the national scheme for appointment of external auditors in future years.

David Brown

TEMPORARY TRAFFIC ORDER APPLICATION FORM (TTRO)

<p>Please Send Your Applications to:</p> <p>Cambridgeshire County Council Street Works Team Vantage House Washingley Road Huntingdon Cambridgeshire PE29 6SR</p> <p>Tel: 01480 372444 Email: street.works@cambridgeshire.gov.uk</p>	<p>Applicants Details:</p> <p>Name: Anthony Brame Address: TBF Traffic, Unit 6, The Lion Barn, Maitland Road, Needham Market IP6 8NZ</p> <p>Tel: Emergency 24 hour Contact No:</p> <p>Email:</p>
---	--

**The cost of this application is:
£1095.00 for a Full Order or £770.00 for an Emergency Order**

YOU MUST ALLOW AT LEAST 12 WEEKS FOR THIS ORDER TO BE PROCESSED. A STREET WORKS PERMIT MUST HAVE BEEN SUBMITTED BEFORE THIS FORM WILL BE CONSIDERED

PLEASE TICK ALL RELEVANT OPTIONS THAT APPLY:

ROAD CLOSURE	✓	FOOTPATH CLOSURE		SPEED LIMIT		OTHER (Please specify below)	✓
Additional T/M Requirements	None <input checked="" type="checkbox"/>	Stop / Go <input type="checkbox"/>		2 way lights <input type="checkbox"/>		3 way lights <input type="checkbox"/>	
Hours of operation _____							
Description of Works: New Connection							
Road Name				Carter road			
Parish / Town				Burwell			
Road Number (i.e.: A140)							
Location of Works				From 112m East of Carter road j/w Martin road going East for approx. 25m			
Closure Start Date:				21/02/2022		End Date: 23/02/2022	

Closure Times: 24/7 or Specify Times	24/7
Working Hours: 24/7 or Specify Times	08:00 – 19:00
<p>Diversion Route – List all roads & parishes (with names and numbers if possible) These can be found on Roadworks.org with “NSG” selected under Operational Info within the Map Layers Menu.</p> <p>Please provide a map showing the extent of the closure and diversion route.</p>	HAWTHORN WAY, BURWELL > MARTIN ROAD, BURWELL & VICE VERSA
<p>Will the alternative route include a Trunk road? (If so it is the responsibility of the applicant to gain agreement from the Highways Agency and submit a copy of the approval to Street Works)</p>	<p>Yes / No</p> <p>Details:</p>
<p>Does the above route have any restrictions, i.e. Low bridges, weight limits, tunnels, fords, ‘one way’ or other Orders on it? (If Yes then please give details).</p> <p>Some of these can be found here</p>	<p>Yes / No</p> <p>Details:</p>
<p>Will this Order apply to pedestrians and/or equestrians? (If so please provide details)</p>	<p>Yes / No</p> <p>Details:</p>
<p>Please add any comments that you feel may assist the application</p>	

Payment Details	
Please specify the details of the company or individual that Cambridgeshire are to collect payment for the TTRO to be processed.	
Company Name: Anglian Water	
Address: Enterprise House Witham Park	Tel. No: 01522 341545

Waterside South Lincoln LN5 7JE	Email: tDixon@anglianwater.co.uk
---------------------------------------	----------------------------------

Your Order Number: 10653759

Please note: It is the applicant’s responsibility to inform residents, businesses, the Local Parish Council and County Councillors about the closure. We may request to see the information you have sent them prior to sending you the legal order. Details can be found by following this [link](#)

FAILURE TO ADHERE TO THE CONDITIONS SET OUT WITHIN THIS DOCUMENT MAY RESULT IN AN APPROVED ORDER BEING WITHDRAWN.

REQUIRED ADDITIONAL IMPORTANT INFORMATION

1. Please ensure you give the official road name with the correct spelling for which the Order is required.
2. Access may be allowed to Emergency Services **IF** safe passage permits.
3. Pedestrian/Cyclist and Access to properties must be allowed at **ALL** times, unless otherwise agreed.
4. An order will only be granted where a suitable alternative route or arrangements are available.
5. A clear map showing the extent of the closure and diversion route must be attached to this application.
6. Signs 1050mm by 750mm bearing the words “This Road will be closed “From To” and including the dates of the closure **MUST** be placed at all approaches to the site **at least 14 days** prior to the proposed closure.

DECLARATION:

All the information given in this application is true and I have checked all the names of streets and parishes against an official map of the area.

Applicant’s Signature: Anthony Brame..... Date: 27/11/2021.....

Company... Tbf Traffic

Position..... Planner

Notes:

- A - Do not install from site closing
- B - All signs must be in accordance with Chapter 6 of the Traffic Signs Manual 2009
- C - All temporary traffic management shall be in accordance with the Traffic Signs Regulations and General Directions 2014.
- D - All temporary traffic management must conform to the Safety of Street Works Regulations 2007
- E - All road works shall be subject to a Traffic Management Plan subject to a written approval from Highways.

KEY:

- Sign
- Traffic Cone
- ▬ Road Closure
- ▬ Access Only
- ▬ Diversion Route

DIVERSION ROUTE

HAWTHORN WAY, BURWELL -> MARTIN ROAD, BURWELL & VICE VERSA

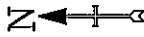

Initial Issue	AB	27/11/21
ISSUE DESCRIPTION	BY:	DATE:
STATUS: FOR APPROVAL		



 The Lion Barn
 Melbourn Road
 Neatham Market
 Suffolk
 Traffic: 01449 490865

love every drop

SITE: Carter Road, Burwell CB25 0DN	
TITLE: Road Closure and Diversion	
DATE: 27/11/21	ISSUED: AS
AS SHOWN	AS
TRAFFIC SCHEME: n/a	REFERENCE: TBF27822

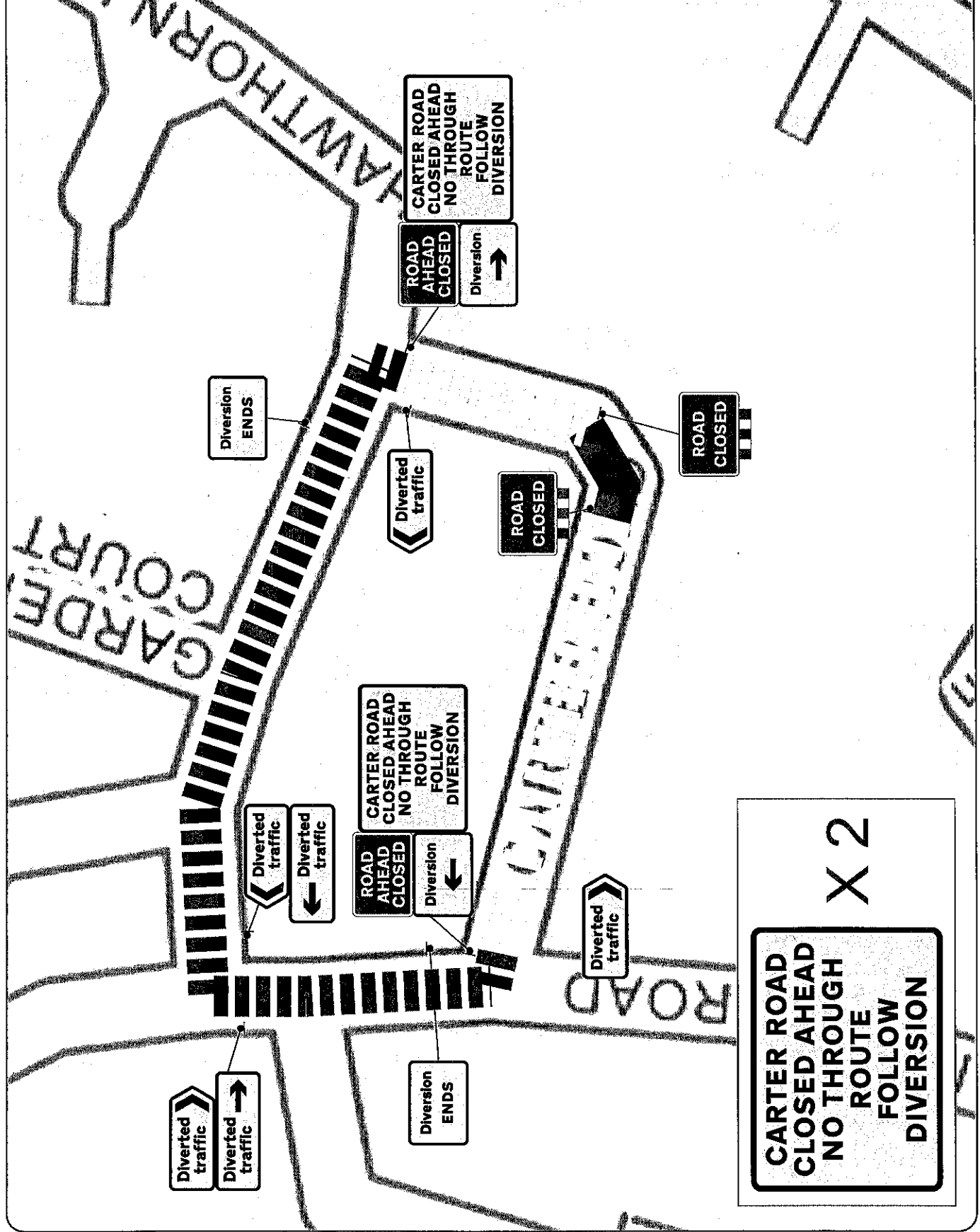

Yvonne Rix

From: Cambridgeshire County Council <cambsc@updates.cambridgeshire.gov.uk>
Sent: 16 December 2021 12:02
To: burwellpc@btconnect.com
Subject: Celebrating Her Majesty The Queen's Platinum Jubilee

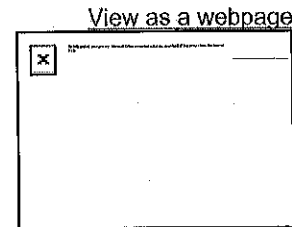
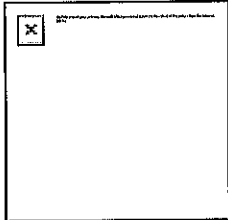

Celebrating Her Majesty The Queen's Platinum Jubilee

In 2022, Her Majesty The Queen will become the first British Monarch to celebrate a Platinum Jubilee, seventy years of service, having acceded to the throne on 6 February 1952 when Her Majesty was 25 years old.

There will be **year-long** Platinum Jubilee celebrations throughout the United Kingdom, the Commonwealth and around the world as communities and people come together to celebrate The Queen's historic reign.

Everybody in Cambridgeshire can get involved and join in the celebrations. Community groups, voluntary services, civic bodies, schools, emergency services, religious groups, businesses, sports clubs and many other organisations can arrange a whole variety of events in every neighbourhood and community in Cambridgeshire.

An extended bank holiday, from Thursday 2nd to Sunday 5th June, will provide an opportunity for communities and people to come together to celebrate the historic milestone. The four days of celebrations will include public events and community activities, as well as national moments of reflection on The Jubilee. Other ways to celebrate during the year include tree planting as part of the Queen's Green Canopy (www.queensgreencanopy.org) or attending Cambridgeshire County Day (www.cambridgeshirecountyday.org)

I very much hope that you will think about how you / your organisation can support your local community, take part, recognise this once in a generation milestone and celebrate Her Majesty's Platinum Jubilee.

Everyone is encouraged to get involved in organising or attending events irrespective of date or location. It is hoped that many events will be arranged and that all communities, faiths and cultures in the County will become involved. To show that you

are part of the countywide celebration, you can add a logo to publicity associated with your Platinum Jubilee events. You can find the logo via www.royal.uk/queens-platinum-jubilee-emblem.

We encourage you to speak with local contacts and work together to organise a celebratory event such as a street party, a community tea party, a BBQ, a concert, a community fete, a religious service of celebration, a carnival or a parade. The Cambridgeshire Lieutenancy will be promoting and supporting events around the county. I and my Deputies will be very happy to attend events you organise as representatives of Her Majesty the Queen.

A dedicated website <https://www.cambridgeshire.gov.uk/council/queens-platinum-jubilee> provides all the information you will need to get involved. It also includes an interactive map to register and view the various celebratory events in your local area along with answers to frequently asked questions.

Thank you in anticipation of your support for this very special occasion to celebrate Her Majesty's Platinum Jubilee.

Kind regards

Mrs Julie Spence OBE QPM

HM Lord-Lieutenant of Cambridgeshire



Stay Connected with Cambridgeshire County Council

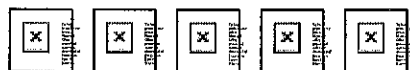

Subscriber services:
[Manage your subscriptions](#) | [Help](#)

This email was sent to burwellpc@btconnect.com using GovDelivery Communications Cloud on behalf of: Cambridgeshire County Council · Shire Hall, Castle St · Cambridge CB3 0AP, UK

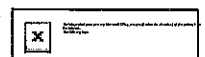



EAST CAMBRIDGESHIRE DISTRICT COUNCIL

THE GRANGE, NUTHOLT LANE,
ELY, CAMBRIDGESHIRE CB7 4EE

Telephone: Ely (01353) 665555
DX41001 ELY Fax: (01353) 665240
www.eastcambs.gov.uk

By email

*This matter is being dealt with by: Richard Kay,
Strategic Planning Manager*

Telephone: 01353 616263

E-mail: richard.kay@eastcambs.gov.uk

My Ref: LP/stage1/Mar21

Your Ref:

Date: 14 December 2021

Dear Sir/Madam

RE: East Cambridgeshire Local Plan – Single Issue Review – Housing Requirements

I am writing to inform you that East Cambridgeshire District Council is consulting on a very limited partial update of its 2015 East Cambridgeshire Local Plan. As the consultation document explains in more detail, this is not a full update of the Local Plan. When only a small update is proposed in this way, it is often referred to as a 'Single Issue Review'.

The update focusses only on updating the overall housing 'target' for the area (sometimes referred to as the 'housing requirement' for the area). There is no expectation that any new land allocations will be made, for example. Please read the document carefully to understand the scope of the consultation and the proposed changes to the Local Plan.

We are currently at an early stage in the process. This is a second consultation stage. We would welcome any views you may have.

Consultation will take place between **14th December 2021 and 23:59 on 7th February 2022**. Full details are available on our website at: <http://www.eastcambs.gov.uk/local-development-framework/local-plan-review> where you can also read all supporting documents.

How to Make Comments

You can make comments:

- By emailing the council at – planningpolicy@eastcambs.gov.uk
- Or in writing, to the above address.

Please be aware that your comments will not be kept confidential and will be made available to the public (including, potentially, online). However, your personal details will be kept confidential in line with the Data Protection Act.

All comments received will be taken into consideration and will help inform the next consultation stage later in 2022.

If you would like to keep up to date with the progress of the Local Plan update, please regularly check our website at <http://www.eastcambs.gov.uk/local-development-framework/local-plan-review> . We may, as appropriate, contact you again when the next stages are reached for this Plan.

If you no longer wish to be kept informed, please let us know using the contact details in this letter - we do not want to contact you unnecessarily.

Yours faithfully

Richard Kay
Strategic Planning Manager
East Cambridgeshire District Council

Yvonne Rix

From: Jennifer Moss
Sent: 07 January 2022 08:47
To: Yvonne Rix; Elizabeth Swift
Subject: Fwd: Re Climate Forum meeting 4 Jan 22 - for your consideration please

----- Forwarded Message -----

Subject: Re Climate Forum meeting 4 Jan 22 - for your consideration please
Date: Wed, 5 Jan 2022 11:12:50 +0000
From: Nicola Hallows <nicola.hallows@gmail.com>
To: Jennifer Moss <jennifer.moss@burwellparishcouncil.gov.uk>

Dear Jenny

I am writing to you as Chair of the Climate Forum, but please do feel free to forward this email to other members of the Climate Forum and Parish Council as you see fit. I strongly believe that the Forum should object to recommendation made by the Assets and Environment Group about verge mowing in 2022. I would like my written comments below to be given full consideration as this was understandably not possible due to time pressures at yesterday's meeting of the Climate Forum.

Firstly, I would like to say that I admire the efforts you are making to motivate the members of the forum and wider council and to contact and engage other organisations and individuals to take meaningful, swift action on the climate and ecological crises. Secondly, I would like to thank you for allowing me, as the representative of Wild Burwell, to raise issues at the forum: I know that there are many issues to be discussed and much work to be undertaken to achieve any kind of progress on the challenging issues we face, as outlined in the BPC climate emergency document. A significant obstacle to taking action is feeling defeated by the scale of the task before we even start, and members of the forum must therefore be firm and bold in our resolve to take steps in the right direction - and for that we need committed members and a lot of energy!

As was evident at the meeting yesterday, many of the steps suggested to progress Burwell's climate change plans are fraught with obstacles - whether financial or political (I'm not suggesting we give up - quite the opposite! - but progress may be slow). The Parish Council has limited power in many areas, and progress is frequently dependent on others or on funding. However, management of grass cutting is one area which is within the control of the Parish Council, and has no cost burden. This is one issue upon which we, as members of the Climate Forum, can take meaningful, immediate, positive action. It's an 'easy win'.

I have heard no challenge to the evidence put forward that mowing verges and other small grassy areas two or three times a year (avoiding the flowering and seed setting season) has a beneficial ecological impact. It seems that all agree that managing these areas for wildlife is a small positive step towards mitigating ecological collapse. You mentioned bees at the end of the meeting: bees - and a whole host of other insects and the systems and creatures they support - need the common wildflowers that flourish with mowing less and mowing later. Surely we have a duty to take the action we know to be right? Surely we have a duty to stop doing (and using public money to fund) what we know to cause harm?

I cannot understand how we, as members of the Climate Forum, can support spurious reasons to maintain the status quo re verge management - the very status quo that contributes to the decline in biodiversity and that teaches our children that manicured monoculture is normal and desirable.

Nature is not a destination, or an isolated fragment behind a fence: the abundance of diverse habitats should be normal, part of our daily trip to the shops or to school. A patch of daisies, dandelions and buttercups is not an eyesore! Why do we need to hide away wildflower areas at the Rec or the Cemetery?

The reasons given by the assets and environment committee for continuing with ten verge cuts per year do not appear to be genuine or grounded in fact - they appear more as a smokescreen for reluctance to change. Liz mentioned the need to 'take the public with us' - surely this could be done by actually taking action to increase the less-mown areas which are visible to all residents throughout Burwell on a daily basis, and using these areas to educate and inform? How else will we 'take the public with us'? There are many accessible areas in Burwell which could be managed for wildlife - but the current recommendation of the Assets and Environment group is that no more verges are managed in this way. This is a huge missed opportunity. I strongly feel that the Climate Forum should challenge this recommendation.

The County Council is in favour of such management of verges, and would be willing to advise if required - the Ecology Officer was in fact booked to visit Burwell last year, but this visit was sadly cancelled by the Parish Council.

With respect to the reasons given by the Assets and Environment group for recommending no change to verge management, as I summarised at the meeting yesterday:

1. Safety issues are surmountable (mowing sight lines where required).
 2. Dog fouling will always be a problem whilst there are irresponsible owners - mowing all grass short isn't going to stop it, any more than concreting over everything will stop it. What do we say to our grandchildren - we were so worried about the dog poo we couldn't try to save the bees and butterflies?
 3. Condoning the actions of residents managing council owned land to their own requirements should be discouraged, not encouraged (unless with explicit agreement of the council - and a green desert is not in line with the Council's own climate change document).
 4. Complaints should be viewed as opportunities to reflect, respond and inform where needed. If complaints are justified, then changes should be made after reasoned consideration of the relevant evidence. We are faced with ecological collapse, but we can do something about it - just a small step - are we so afraid of complaints about tidiness that we cannot act? Whilst I have always wanted to work with the Council rather than in opposition, if I had framed my multiple requests to permit wildflowers to grow on verges etc over the past five years as complaints, would these have carried any weight? Should I - and others - complain that the Council is knowingly harming habitats in order to effect change by the Council? If that's the way to go, I will do so - but I suspect it's not.
 5. Any 'confusion' caused by changes can be overcome with education.
- Residents can be informed, contractors instructed. Change often leads to questions - and answering questions is our opportunity to educate and involve, to start the debate. And really it's not such a major change: longer grass and flowers in the summer - I think most people can deal with that without too much upset if they know why the action has been taken.

I also reiterate that other councils across the country are taking action to improve biodiversity - and there aren't riots in the streets.

Take a trip to Wilbraham in the spring and summer - every verge and patch of grass is unmown. Teversham instituted wildlife friendly mowing on road verges last year - ten compliments and one complaint (resolved by mowing a little path across a verge from a bus stop).

Change is possible and in our gift. We just need to have the courage to take what we know to be the right steps. We are the Climate Forum - if not us, then who?

And after all, if the science changes to say that frequently mown grass is /better/ for wildlife and the climate, we just mow it again! It's not an irreversible decision!

Finally, you mentioned I should get in touch about joining the community garden team - please do let me know how to go about this.

Thank you for your consideration.

Best wishes
Nicola

LETTER FROM WILD BURWELL CONCERNING THE RECOMMENDATIONS OF THE ASSETS AND ENVIRONMENT GROUP TO FULL COUNCIL

Date 07/01/2022

To the Clerk, Chair and Vice Chair of Burwell Parish Council

Dear Yvonne, Liz and Paul

Minutes of the meeting of the Assets and Environment Group of 29/11/2021 were made available to Climate Forum participants on 04/01/2022 by the Clerk. The minutes included detailed recommendations about the 2022 parish grass cutting.

We appreciate the time, effort and thought contributed by parish councillors in considering grassland management requirements for individual sites.

We are very pleased about the 2022 plans for Priory Meadow, the Recreation Ground borders, Hall Lane Green and part of the cemetery. We also welcome the support for our proposal to plant trees and shrubs on Bolton Close green. We will be pleased to help with the community garden at the Recreation Ground.

However, we are disappointed about the proposed mowing regime for Pound Hill, and that there are still plans for a community garden on Pound Hill.

The best sites for wildflowers in the built-up area of Burwell are Spring Close and Pound Hill. Both areas have well-drained chalk soils which support a wide variety of flowering plants including spring flowering buttercups. Both areas are remnants of the meadow vegetation of the village in past times.

We ask that our concerns about Pound Hill are debated at the full Parish Council meeting on 11/01/2022 when the recommendations of the Assets and Environment Group about parish grass cutting are presented to council.

We urgently request

- That no new structures are placed on Pound Hill other than a couple of benches as a raised bed of wildflowers is inappropriate when there are perfectly good wildflowers already growing on the site
- That the mowing of Pound Hill is delayed until at least the end of May 2022 to allow the buttercups to flourish, and that instructions are given to the grass cutting contractor to exclude Pound Hill from the mowing rota until the end of May. Perhaps the Maintenance Officer could trim a metre wide strip around the perimeter during that time.

Yours sincerely

Martin O'Leary, Chair, Wild Burwell Nicola Hallows, Secretary, Wild Burwell

Climate Change Forum

4th January 2022 7.30 pm on Zoom

Minutes

Present: Jenny Moss (Chair), Gill Miller, Jim Perry, Liz Swift, Michael Swift, Geraldine Tate, Paul Webb, Brenda Wilson, Paul Pickles, Linda Hart, Nicola Hallows, Martin O'Leary, Yvonne Rix (Clerk)

1. Apologies for absence
Helen McMenamin-Smith
2. Approval of the minutes of 2nd November 2021
The minutes of the meeting held on 2nd November 2021 were approved. Proposed by Jim Perry and seconded by Michael Swift.
3. Climate Action Sheet

Item	Action Required	Person/Status
Climate Action Policy		
Energy usage and sources	Assess BPC Carbon Footprint Encourage use of https://footprint.wwf.org.uk/ Share on our website and BEG FB page Letter to Clunch	The Clerk explained that it would not be easy to put together all the information required. Using one building as a representative may be an option. It was suggested that it may be more appropriate for an outside organisation to be approach to carry out any carbon footprint assessment agreed and that this suggestion should be made to Full Council.
Transport and travel	EV Charging Points Cycle paths	Paul Webb to contact Emily Bolton re possible ECDC grant for EV Charging Points. Council has applied for funding for EV Grants for GMH through English Heritage – Result of application should be known late January early February. BEG looking at possible locations for charging points and the British Legion has been suggested. They will also be contacting businesses to see if they would be willing to have a point installed. Possible BEG Subgroup to be formed to look at potential cycle paths for example to the new Soham Train Station. Paul Webb made all aware that the Burwell Cycle Club had provided the Council with a report on cycleways in the village and this could be made available to BEG.
Agriculture and food	Promote local produce Liaise with BAGs over allotments Work with local farmers	Jen sent letter to Clunch Jenny Moss in discussion with BAGS regarding a possible Open Day at the allotments. The suggested date is the same as the date proposed for the Pauline's Swamp Open Day. This could work, with the two events publicising each other.

BEG – Burwell Environment Group

BAGS – Burwell Allotment and Gardening Society

BPC – Burwell Parish Council

WB – Wild Burwell

CCC – Cambridgeshire County Council

ECDC – East Cambs District Council

		<p>The Forum is still keen to have a representative from the local farming community. Brenda Wilson to try to establish a list of farmers in the village so that a letter from the Parish Council can be sent to them explaining about the Forum and asking if anyone would like to be a representative. Michael Swift made the Forum aware of possible future Government policy to encourage farmers to plant hedging and wildflower areas on their land</p>
Housing and infrastructure	<p>Focus on the need for new builds to be carbon neutral</p> <p>Neighbourhood Plan</p>	<p>Jenny Moss had received a response from Lucy Frazer MP (Appendix 1)</p> <p>An email had been received from BEG asking the Parish Council to consider having a Neighbourhood Plan. Michael Swift explained that under different guises, Neighbourhood Plans had been going for over 30 years and that the work involved in putting a plan in place is immense, and that a plan would not change override Government legislation regarding building standards. New housing already must meet Government environmental legislation and would therefore not recommend having a Neighbourhood Plan. If the Council did decide to have a plan, work on the document is likely to take three to four years, with extensive consultations with the Parish, a costly referendum and inspection by the Planning Inspectorate. ECDC has a Local Plan which each Parish submitted content to be included. The Clerk advised that if the Council wished to consider having a Neighbourhood Plan that an extensive study on what should be included, what is achievable, what legislation is already in place in comparison with the work and the costs involved in compiling the plan.</p> <p>Liz Swift explained, in response to a comment that the Parish Council appeared to have a defeatist attitude to Neighbourhood Plans, that the Council is exceptionally busy, managing many properties and projects and is being pragmatic and realistic on achievable workloads for staff and Councillors. It was suggested that as many people as possible should lobby MPs, and the County and District Councils regarding building properties to high environmental standards.</p>
Local business		<p>BEG members are writing to local businesses regarding having EV points. Nicola Hallows asked what plans the Forum has for involving businesses, as some businesses may be willing to offer some sponsorship. Jenny Moss explained that she had written to around 30 local businesses for sponsorship for the Community Gardens and only one had responded. Involving the local Co-op may be an option. Jenny Moss to speak to Steve Smith the local manager soon. The Co-op does however have to comply with national guidelines for the support they can offer to the community.</p>

BEG – Burwell Environment Group
 BAGS – Burwell Allotment and Gardening Society
 BPC – Burwell Parish Council
 WB – Wild Burwell
 CCC – Cambridgeshire County Council
 ECDC – East Cambs District Council

Waste and resources	Promote recycling/upcycling Water refill stations Repair Cafe	Jenny Moss to ask the Co-op if they would be willing to have a water filling station. The tap at the Recreation Ground could be added to the 'Water Fill App' that is available. The Anchor Pub in North Street also has a water filling station. Water filling stations to be discussed at the next Community, Leisure and Sports Group meeting. Possibility of a Repair Café being set up to be discussed at the next Community, Leisure and Sports Group.
Environment and land use	Tree Planting Wild flowering Community Gardens Environment Agency	Disappointed that neither the CCC nor ECDC has land available. Wild Burwell/Tree Nursery have permission to plant some trees establishing in the Tree Nursery on National Trust land. Concern was raised about how established trees outside the Conservation Area have no protection against felling unless there is a Tree Protection Order assigned to them. Clerk to find out who controls which areas are designated as Conservation Areas. It was suggested that additional tree planting could take place on the arable field side of Pauline's Swamp. All members of the Forum have received a copy of the Parish Council Asset and Environments Group recommendations for the 2022 grass cutting season (Appendix 2). Nicola Hallows while agreeing with many of the recommendations was opposed to the 10 cuts proposed for the verges and felt that the reasons given for this decision were not justifiable and asked that the Climate Change Forum voting against the recommendations made by the Asset and Environment Group. Liz swift explained that the Assets and Environment Group is aware of the need for biodiversity but had to consider all residents views and move forward with a balanced approach taking into account all these views. By making changes slowly, would allow for residents to be made more aware of the need for biodiversity. Paul Webb explained that the Council would look to work with Wild Burwell with the design of the Community Gardens on Pound Hill and at the Recreation Ground to incorporate wildflower aspects. He explained where verges were concerned, safety was paramount and that the Parish Council did not have control over the cutting of all the verge areas in the village. Some concern was raised over the need for raised beds within the Community Garden. Martin O'Leary voiced that should the Parish Council go ahead with the community garden on Pound Hill he would need to consider his position on both the Climate Change Forum and the Spring Close Management Group. Jenny Moss suggested that Nicola Hallows should work with the Community Garden Group (Jenny Moss, Paul Webb and Helen McMenamin-Smith). Nicola Hallows agreed that she would be willing to do this. Paul Pickles who had previously worked for Anglian Water informed the Forum that he was willing to share his knowledge about the lode and the sewerage works with the Forum. He

BEG – Burwell Environment Group
 BAGS – Burwell Allotment and Gardening Society
 BPC – Burwell Parish Council
 WB – Wild Burwell
 CCC – Cambridgeshire County Council
 ECDC – East Cambs District Council

		<p>explained that Burwell is in a fortunate position to have no water sources travelling into the village from higher ground. It also has no areas of long-term flooding. At the point when he left Anglian Water six years ago the sewage system was working well and there was still capacity in the system for growth. When issues arise, modelling is carried out and required adaptations made to ensure that the system remains within the legal requirements. Residents should be aware of the damage that can be caused to water ways, such as the Lode and the catch water drain, where all ground water drains within the village flow in to, when individuals clean their vehicles on the road.</p> <p>Concern was raised about the management of the ground through spraying being carried out under the solar panels at the Goose Hall Solar Farm. It is thought that original the ground was due to be kept clear by the grazing of sheep. Paul Webb to look at the initial planning application and consent.</p> <p>Paul Pickles was asked if he had any knowledge or advice on Chalk Streams and their management. The Lode has deteriorated over the last 40 years, Paul Pickles explained that the feeding of the ducks and swans particularly with animal food is detrimental to the chalk stream. Around ten years ago, Anglian Water had introduced a phosphate filter to prevent the main lode up to the Cock-Up Bridge suffering from similar damage. The Spring Close Management Group will be looking at the stream head at their working day to be held on Saturday 22nd January at 10 am and Paul Pickles was invited to attend. Maintenance of the stream head is also included in the Spring Close Maintenance Vision Plan.</p>
Village Survey		More information such as content topics, funding available, formats, online etc required.
Green Open Day		No further discussion took place.

4. Any Other Business

Jenny Moss asked for suggestions for content in the next letter to Clunch. Suggestions included how long bees had been in existence for, the way previous generations carried more out by hand than now a days and why washing vehicles on the road is bad for the environment.

5. Date of the next meeting

The next meeting will be held on 1st February 2022 7.30 pm. Whether this meeting should be held on Zoom or Face to Face will be dependent on Covid closer to the time.

Signed:

Dated:

BEG – Burwell Environment Group
 BAGS – Burwell Allotment and Gardening Society
 BPC – Burwell Parish Council
 WB – Wild Burwell
 CCC – Cambridgeshire County Council
 ECDC – East Cambs District Council

Meeting of the Assets and Environment Group held on 29th November 2021 at Mandeville Hall.

Present: Joan Lonsdale (Chair), Robin Dyos, Liz Swift, Michael Swift, Geraldine Tate, Paul Webb, and Yvonne Rix (Clerk)

Apologies for Absence – Derek Reader and Lea Dodds

Purpose of Meeting

The meeting was arranged to discuss the management of grassed areas in the village including Council owned open spaces and County owned verges.

Introduction

All present had either attended the Climate Change Forum meeting held on 4th November 2021 or had seen the reports from Martin O’Leary (Wild Burwell) and Nicola Hallows (Wild Burwell) presented at the meeting.

The Group noted that Burwell, in comparison with many other villages, is fortunate to have two established areas, Pauline’s Swamp and Spring Close, which are managed to encourage flora and fauna. The village consists of dwellings, many with gardens.

The Group took into account the following considerations when making the proposed recommendations to Full Council (meeting of 11th January 2021). The Group is open to suggestions and will monitor and review throughout the following years.

Considerations

- Safety
- The 2022 Grass Season will be the second year of a three-year contract with Truelink
- The need to increase areas where wildflowers can establish in the village
- Local pride in the village
- The need to look at the wider picture and the views of all parishioners

Proposal

Area	Proposal	Reason
Individual gardens	Residents encouraged to create their own wildflower areas	As suggested by Wild Burwell to create a corridor of wildflower areas for bees and other insects.
County Council Verges including the Causeway	That the verges are managed in the same manner as 2021 with up to ten cuts per year.	<ul style="list-style-type: none">• Safety – Traffic and Pedestrian• Dog Fouling• Residents cutting and looking after the verges adjacent to their properties• There have been no complaints from residents this year regarding the verges, indicating that the contractor has conducted the cutting satisfactorily, making changes to which verges are cut during

		the term of the contract is likely to cause confusion for all.
Spring Close	To cut as per 2021	
Pauline's Swamp	To cut as per 2021	Once the area of land adjacent to Pauline's Swamp has been transferred, it is likely (subject to Pauline's Swamp Trustees Plan for the area) that this will be managed to encourage the growth of wildflowers etc.
Priory Meadow	To be cut with grass collected, twice per year to encourage wildflower growth. One cut early in the season and one cut late summer. Footpaths to be cut to allow access to woods, benches etc. Discussion to be had with contractor to check that they have the necessary machinery to cut and collect grass and as to the cost implications for collecting the grass	To create a further large area managed to encourage wildflowers.
The Recreation Ground	Allow the perimeter of the field outside of the trim track to be established as wildflower areas. Regard will need to be given to cutting of the hedges in the spring and late autumn. Care must be taken to prevent weed growth on the exercise areas and on the tarmac trim track. For a Community Garden (benches etc) to be created on the area adjacent to the new car park, with the remaining area to be managed to encourage the growth of wildflowers. It is proposed that Wild Burwell could manage the wildflower areas at the Recreation Ground but would need to submit a plan detailing their intentions to the Council for approval first.	To create further areas for wildflowers.
The Cemetery	To use the rear, currently unused, sections of the	Creation of further wildflower areas.

	<p>cemetery to be managed in a way to encourage wildflowers. The areas to be clearly marked as wildflower areas and have a cut border around the sections.</p> <p>The remainder of the cemetery to be cut in the same way as 2021.</p>	
<p>Junction of the Causeway and Silver Street</p>	<p>To be managed as a wildflower verge. Care needs to be taken with this area as it is an awkward junction for vehicles. Height of growth to be monitored to ensure visibility and area to have a cut edge</p>	<p>Creation of further wildflower area but awareness of the need for road safety.</p>
<p>Junction of Hall Lane and Park Road</p>	<p>To be managed as a wildflower area as in 2021</p>	
<p>Pound Hill</p>	<p>Community Garden to be constructed as agreed by Full Council 13th July 2021. The remaining area to be cut as per the same cutting regime as the verges up to a maximum of ten cuts per season.</p> <p>That raised beds are included in the Community Garden which can be used for the growth of wildflowers</p>	<p>To enable the creation of the Community Garden providing additional seating for residents in this central area of the village.</p> <p>To create an area for wildflowers whilst taking into account the differing views of the community.</p>
<p>Bolton Close Areas all owned by ECDC</p>	<p>To support the request made by residents to Derah Seward (Wild Burwell) to ask ECDC to approve the planting of additional trees and shrubs to block the view of Ashgrove from Bolton Close.</p>	<p>Not only will this improve the outlook for Bolton Close residents but also of Ashgrove residents overlooking Bolton Close.</p>

TREE PLANTING

Dear Richard, and Emily,

Burwell Parish Council recently held their first Climate Forum - a group comprising of mostly Councillors, but also representatives from other interested parties in the village.

We thought the best way to proceed was to actually work through our Climate Change policy, to work out how we can take positive action to realise our pledges.

There is a very keen group in the village called Wild Burwell, who have set up a small tree nursery on a part of Parish land, and are ready, willing, and able to plant as many trees as they can get their hands on. Our problem is Land, though, or lack of.

Can CCC or ECDC suggest any land that they have to offer? Even better than trees dotted about the village would be another project on the scale of Priory Woods, where the villagers pull together to plant up an entire field.

I look forward to hearing from you,

Jenny Moss

Good morning Jenny,

Thankyou for your query regarding land for tree planting.

Unfortunately we have not been able to identify land in Burwell suitable for planting. All of our county estate in Burwell is let to farmers on farm business tenancies at the moment, with the rental income generated providing revenue to deliver our front line services. Taking land out of agricultural production for trees has a significant adverse financial impact as well potential environmental impact e.g. increasing food miles, so we have to be careful in how we designate land for planting. We hope that the emerging environmental land management scheme from government will help to shift the financial implications of tree planting to be positive in the near future.

While we are unable to offer any land for you to plant on, we have a number of projects in development where we will be undertaking strategic planting of trees and hedges, for example along Heath Road this season (Dec-Feb) to break up the landscape and make access onto our land more difficult for hare coursers. More widely we are actively progressing plans elsewhere in the county for larger scale planting in support of the Queens Green Canopy project - for example at Landbeach and potentially Lower Valley Farm, Fulbourn.

If you have any further queries please do get in touch.

Kind regards,
Emily

Emily Bolton
Climate Change Officer

ECDC also said they had no available land.

~~~~~

## HOUSING

Dear Lucy,

You will be aware that Burwell is to have 350-450 new houses built on Newmarket Road. A local group called Burwell Environmental Group emailed ECDC to request that strict zero carbon measures were enforced on the development that the developers must adhere to, however ECDC replied:

"Regarding your point on house building, I have spoken to the planners at ECDC and they have expressed frustration that at this stage we can't insist on doing more. There are a number of reasons for this but primarily it is national policy which doesn't allow us to insist on going beyond building regulations or require other carbon-reduction measures such as PV panels on roofs."

Burwell Environmental Group have a representative on the Burwell Parish Council Climate Forum, and made us aware of this response. As chair, I offered to email you asking why there isn't a National Policy in place that insists on new builds being zero carbon. Surely all new builds should have proper insulation, ground source heat pumps, solar panels, EV charging? Not next year or by 2030, but NOW (or several years ago...). I don't understand why there could be any reluctance on the part of the government to make this the policy.

Many thanks for your time,

Jenny Moss

Burwell Parish Council Climate Forum Chair

Reply called HousingLF.pdf

#####

## FARMER INVOLVEMENT

Hi Michael,

I presume you know about the newly formed BPC Climate Forum? It consists of a few PC members, and a few representatives from various interested/active groups in the village. It would be good to have someone from the farming community attend the forum meetings, or even just come to give a talk on evening on how farmers are handling the climate crisis.

I heard that some NFU farmers are liaising with the Wildlife Trust, that some are trying to change the crops they grow to adapt to wetter conditions, that most are anxious that their land and therefore heritage is eroding as winds blow the top soil off. But I don't know if any of this is true. Some farmer at the back of Pauline's Swamp has just bulldozed down a bunch of trees and shrubbery, taking our fence down into the bargain.

It would be useful to hear if any farmers would have wild hedging planted round their fields. That sort of thing.

Do you know anyone local who would be interested in taking this up?

Thanks, Jenny

No reply from Michael yet

#####

**CARBON FOOTPRINT**

Hi Jenny

To assess BPC footprint, I would need things like:

- 1. copies for a full year of your electricity and gas bills, for any buildings BPC owns.
- 2. any mileage any BPC councillor does, on BPC 'business' (if this is recorded)
- 3. litres of fuel purchased in a year for any maintenance vehicles (eg mowers) you have.
- 4. if you can think of anything else which BPC owns and uses which requires fossil fuels or electricity to operate, then I will need that data as well (eg street lights? Any other lit information boards? ....?)

It won't be perfect, but with above, it will be a start.

For homeowners, I personally find the WWF one the easiest (Witchford refer to it in their website)

Thanks

Richard

#####

**BAGS OPEN DAY**

Dear Angela,

Burwell Parish Council have newly formed a Climate Forum. We had our first meeting at the start of the week, and one of the subjects we discussed was how to educate the villagers about the importance of eating local fresh produce. We wondered if BAGS would be interested in holding an Open Day for the public to come and get ideas and hints for growing their own veg?

Don't worry if you don't want people trampling all over your potato beds - it's only a thought!

Regards,  
Jenny

Dear Jenny,

Good to hear from you, and apologies for not replying sooner – I've been away.

This sounds like a good idea but the BAGS committee will need to take a view. I will copy this to Caroline (BAGS Chair) as we will need to discuss the timing and other details of how best to manage such an event.

Good wishes,

Angela

Dear Jenny,

Sorry to have been ages in coming up with a proper response but we have now just had a committee meeting to discuss this.

We agreed this is well worth trying and, in order to engage potential growers at the beginning of the season, we thought that we could have an Open Afternoon from 2-5pm on Saturday 23 April. Some allotment holders would be around to answer questions and we might have some surplus seeds to hand out.

Perhaps you could let us know in due course whether the Parish Council and the Climate Forum sees itself contributing or being involved in the occasion? I presume we liaise with you to discuss the details of the event?

Best wishes,

Angela

Dear Angela,

I'm delighted with your response, and of course I would love to liaise and help organise! Unfortunately the 23rd April has been earmarked for the Pauline's Swamp Open Day. Would you be able to shunt your Open Afternoon back or forward a week? If not, I can still help organise (and will ask fellow Councillors), but won't be able to attend on the day.

Burwell Grow and Share Facebook page will have members who will also get enthusiastic about this.

Many thanks,  
Jenny

#####

**ENVIRONMENT AGENCY**

Hi Jenny,  
Thanks for contacting me about the Climate Change Forum of BPC.  
Yes I would be pleased to help in any way I can. I will read through the minutes of the BPC action plan and then let you know what I am working on.  
Regards  
Paul

Sent from my iPhone

On 30 Nov 2021, at 11:58, Jenny Moss  
<[jennifer.moss@burwellparishcouncil.gov.uk](mailto:jennifer.moss@burwellparishcouncil.gov.uk)> wrote:

Hi Paul,

It was suggested at the last BPC Climate Forum that you might have useful knowledge that you can share with the group on Climate Change. The Forum comprises of several Parish Councillors, and so far

representatives from Wild Burwell, Burwell Environmental Group, Burwell Belles, and Spring Close.

Our aim is to look at the Parish Council's Climate Action Plan to see what we can actually take action on. Any further information about our changing environment and any action we can take to mitigate the effects of climate change would be very welcome. Do you feel that you would have anything to contribute at our next meeting on 4th January, or by written word?

Many thanks,

Jenny Moss (chair)

#####

**BEG: NEIGHBOURHOOD PLAN**

Hi Yvonne and Jenny,

I am writing to you on 23rd December, but I imagine this will not get read until after Christmas, in which case I would like to wish you both a Happy New Year!

I am writing to you following a meeting of BEG during which our new housing estate was again discussed. It is becoming apparent that if we are to take any meaningful action to mitigate climate change, and BPC has announced that there is an Emergency in this regard, then Burwell needs to have a Neighbourhood Plan. A quick check shows me that the following villages already have, or are working on, their own Neighbourhood Plans: Fordham, Soham, Isleham, Swaffham Prior, Swaffham Bulbeck, Reach. We in BEG think that we also need to have such a plan in Burwell, and are writing to the Clerk for BPC and also the Chair of the BCC forum to ask that the council agrees to discuss how to instigate the process of creating a plan, and that we discuss this at the next meeting of the forum, respectively.

In view of the climate emergency, I would suggest that the creation of a Neighbourhood plan for Burwell is a very high priority project.

I look forward to bringing this topic forward in the New Year.

With kind regards,

Linda

---  
Burwell Environmental Group ( BEG)  
**[burwellbeg@gmail.com](mailto:burwellbeg@gmail.com)**





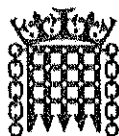

HOUSE OF COMMONS  
LONDON SW1A 0AA

Mrs Jenny Moss  
Folly Bridge  
Waterside  
North Street  
Burwell  
Cambridgeshire  
CB25 0BJ

2 December 2021

Dear Jenny,

Thank you for contacting me about housebuilding in Burwell and concerns about their adherence to Net Zero. I have also been contacted by the Burwell Environment Group directly regarding this matter and I have shared this response with them.

I understand your concerns. Climate change is one of the greatest challenges we face and I agree that urgent action is needed.

To achieve net zero emissions by 2050, both new and existing homes need to become more energy efficient and switch to low carbon heating. I welcome the energy efficient standards set through the Building Regulations for new homes and non-domestic buildings. From 2025, the Future Homes Standard (FHS) will ensure that new homes produce at least 75 per cent lower CO<sub>2</sub> emissions, compared to those built to current standards. It is encouraging that the Government has accelerated work on a full technical specification for the FHS, which will be consulted upon in 2023, with the intention to introduce the necessary legislation in 2024.

Crucially, homes delivered under the FHS will be 'zero carbon ready', which means that in the longer term, no further retrofit work for energy efficiency will be necessary to enable them to become zero-carbon homes as the electricity grid continues to decarbonise.

I know many people want this to be implemented quickly, and I am told that an interim uplift, effective from June 2022, will be brought forward to deliver a meaningful reduction in carbon emissions and provide a stepping stone to the FHS in 2025. New homes built under this standard are expected to produce 31 per cent less CO<sub>2</sub> emissions, compared to current standards.

With regards to the planning process, The National Planning Policy Framework will also play a vital role in our green revolution, setting out how planning can contribute to our low carbon future. I am pleased that the Government intends to go further, which is why the Planning for the Future White Paper proposed reform of the framework so that the planning system can most efficiently play a role in mitigating and adapting to the effects of climate change at a local and national level. The

framework has already been updated with a stronger focus on creating beautiful buildings and homes and includes a new expectation that all new streets are tree-lined, alongside measures to improve biodiversity and access to nature through design.

All levels of government have a role to play in meeting our net zero goal and I am pleased that local authorities are rising to the challenge. Ninety-eight per cent of local authorities are already voluntarily taking action to reduce emissions, and these reforms to the planning system will help local authorities further, improving the delivery and quality of homes and neighbourhoods. I am aware that the Government is currently collating, reviewing and analysing responses to the Planning for the Future consultation.

Thank you again for taking the time to write to me. I hope this response is helpful.

Yours sincerely,

A handwritten signature in black ink that reads "Lucy Frazer". The signature is written in a cursive, flowing style.

**Lucy Frazer MP**